

Horizon Select LED Panel Installation Guide

Version 1.0

IMPORTANT: Please take the time to read this installation guide relating to the following products: ELHSPN and ELHSPC Horizon Select Panels.

- Inspect the product before installation. If there are any obvious defects do not install and contact your local retailer.
- Always isolate the power before carrying out any work.
- It may be necessary to upgrade your MCB's to allow for the increased inrush of current.
- The installation should be carried out by a qualified electrician and the installation complies with IEE regulation BS7671:2008

In the box:

1 x LED Panel
1 x LED Driver

Installation

- Isolate mains power.
- Remove the insulation cover (AC side only) and Connect the mains supply to the LED driver (Note the power supply is a Class II double insulated product).
Live: Brown
Neutral: Blue
- Replace and secure the insulation cover.
- Connect the LED Driver to the LED panel via the male/female plugs. Insert and twist to lock and make a secure connection
- Place the LED driver in a safe location ensuring good air flow. Ideally to the side of the panel but away from any heat source or insulation material.
- Restore the mains power and test for satisfactory operation.

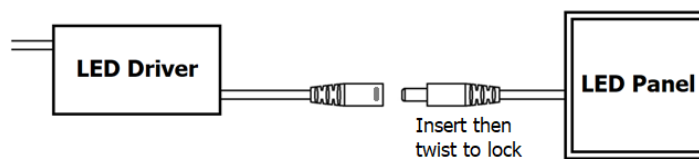

Adjusting the brightness:

- The Horizon select is pre-set to the highest brightness of 36W 3800 Lumens. If you find this too bright you can lower the brightness to a more comfortable level by following the below procedure.
- Isolate the mains power supply.
- Locate the LED driver and remove the insulation cover on the AC mains input.
- You will see two DIP switches and they will be in the ON position.
- Using a small flat screw driver change both switches to the down position, replace the insulation cover and restore the power to check if the brightness is satisfactory for the environment. The panel will now operate at 30W 3200 Lumens.
- Restore the mains power and test for satisfactory operation.

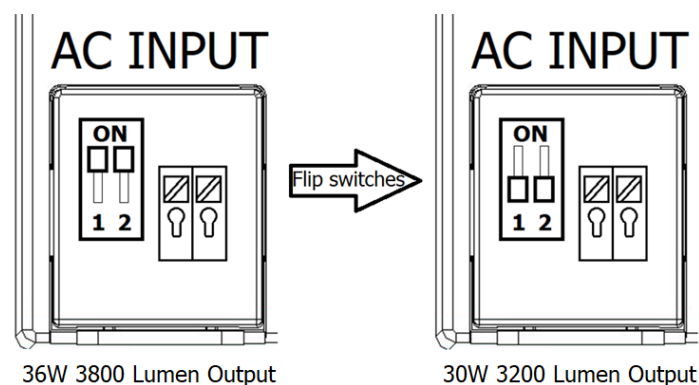

Installation (False Ceilings):

- 1) Type of installations
 - a. For upgrades of existing installations identify where you wish to locate the LED Panel and carefully remove any ceiling tile or existing fitting.
 - b. For new Installations it is recommended to fit the LED Panels before the rest of false ceiling is installed to allow easy access and also the chance to easily relocate should you be unhappy with the light distribution.
- 2) First wire the supplied LED driver to the mains power supply. (For dimmable connect to the relative control wires and for Emergency versions refer to the Emergency product wiring diagram)
- 3) Carefully move the LED panel into the ceiling aperture ensuring there is at least a 100mm gap between LED Panel fittings to allow heat to dissipate effectively and connect the LED driver to the Panel.
- 4) Ensure the panel sits securely within the ceiling grid and that the driver is located to the side of the panel and has adequate ventilation to remain cool.

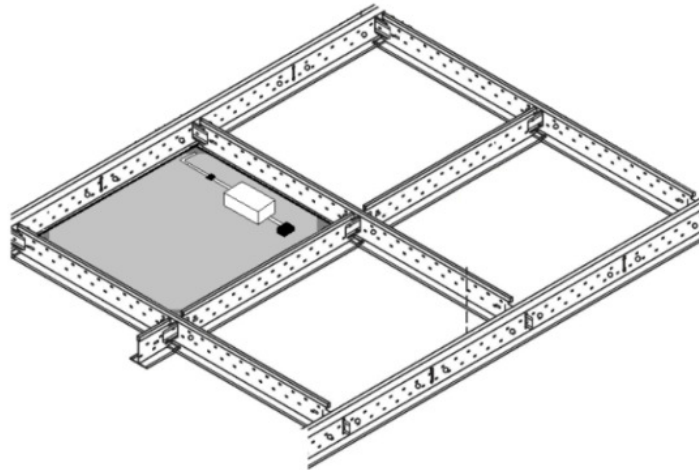

LED Panel Spec:

Item Code:	ELHSPN		ELHSPC	
AC Input	220-240Vac (50/60Hz)			
Colour Temp:	4000K		5000K	
Wattage:	30W	36W	30W	36W
Lumen Output:	3200lm	3800lm	3200lm	3800lm
CRI:	>80			
Working Temp:	-20°C to 30°C (Emergency version 0°C to 25°C)			
Dimensions	595 x 595 x 30mm			
Weight:	1.7KG			

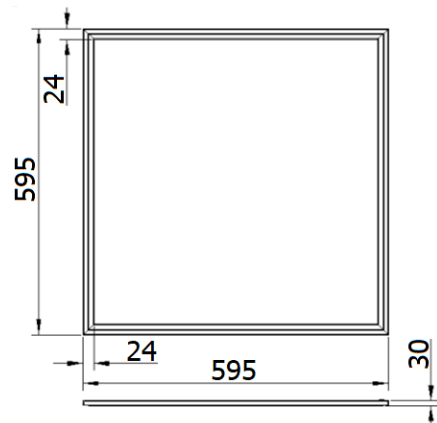

Accessories:

Surface mounting trays: Are available separately to allow fitting to a solid flat wall or ceiling.

Suspension kits: All the LED panels are compatible with ceiling suspension kits. Suspension cable can be easily connected to the four allocated screws on the panels.

Advice:

Thermal Management: Where LED products are installed with less than 100mm spacing between them, the risk of failure due to inadequate heat management is high and this will invalidate the warranty as per our terms and conditions relating to the correct installation of products. Also ensure there is no insulation covering the product or the LED power supply.

Warranty and Specification: For full specification, extended warranty applications and warranty terms and conditions visit www.novah.co.uk

