

Model

iBC-BB60

60.8" Back Bar Cooler with Solid Doors



Key Features

- Exterior dimensions (WDH) 60.8" x 25.8" x 35.6"
- Stainless steel top; corrosion-resistant vinyl steel exterior
- 2 self-closing solid doors
- Adjustable PVC-coated shelves
- LED interior lighting
- Temperature range of 0.5° to 5° Celsius (33° to 41° Fahrenheit)
- 15.8 cubic feet of storage
- Electronic controls
- Environmentally-friendly R290 refrigerant
- Two year warranty on parts and labour. Five year warranty on the compressor parts.

iBC Food Equipment Inc. Back Bar Coolers

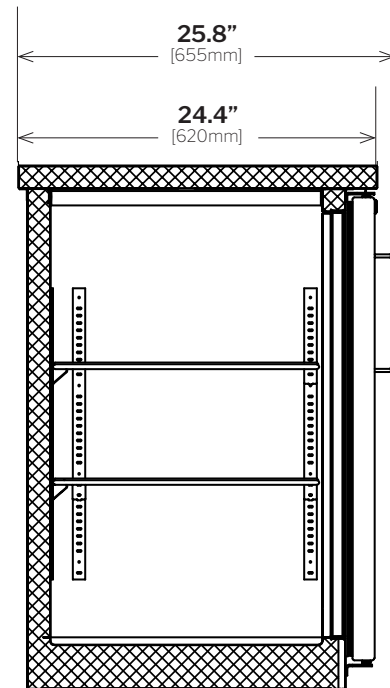
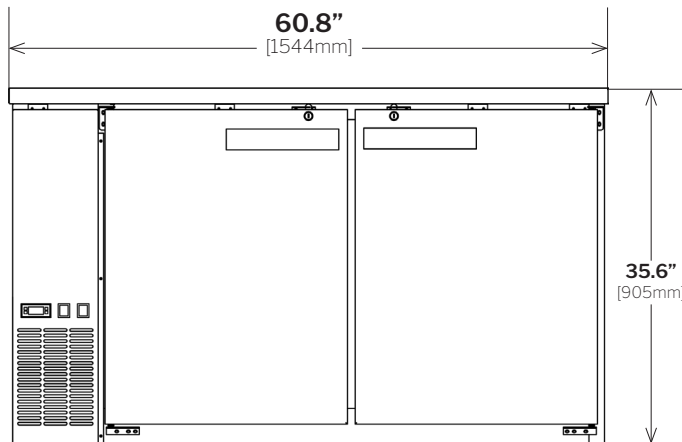

Model	Refrigerant	Electrical	NEMA Config.	Net Weight	Ship Weight	Shipping Dimensions
iBC-BB60	R290	115 v / 60 hz / 2.88 a / 1 ph	5-15P	291 lb	319 lb	63.4" x 27.6 x 42"



Natural Resources
Canada Approved



ETL Electrical Listed
USA & Canada



ETL Sanitation
Listed



Environmentally-friendly
R290 Refrigerant

Due to our ongoing dedication to product improvement, all specifications are subject to change without notice.

