



Installation Instructions

Parts List

- Aluminum Retainer
- Vinyl Cover
- Mounting Hardware

Pre-Installation Notes

The factory recommends using back up channels at stud wall conditions. Check to ensure the anchors supplied by the factory will work with the type of wall substrate on the project.

Installation Steps

STEP 1

After framing is completed, install gypsum wall board on the steel stud framing using the proper drywall setback measurements for correct type of flush mount corner guard (**FIGURES 2, 3, and 4**).

STEP 2

Mark the locations for the fasteners on the aluminum retainer. Fasteners should be placed 3" for the top and bottom, then 14" O.C. Be sure to stagger fasteners on the opposite sides of the retainer.

STEP 3

Position the aluminum retainer over the framing at the corner. Ensure that the retainer's flanges overlap on the gypsum wall board, and that the retainer is properly aligned with the wall. Using the marks on the retainer (Step 2) install the retainer on the corner by securing the retainer to the steel

**Self-adhesive corner guards are easy to install, but will break down in high traffic areas more quickly than a corner guard that is fastened with holes and screws.*



INSTALLATION INSTRUCTIONS

► Flush Mount Corner

stud on each side of the corner with self-drilling, self-tapping screws provided. Ensure that the retainer's flanges remain correctly lapped over the gypsum drywall as they are attached to steel stud.

STEP 4

Cover the exposed flanges of the aluminum retainer with drywall joint compound (by others). Feather the edges as necessary.

STEP 5

If the corner guard is less than the full height of the wall, or trimming is required, measure and cut the vinyl cover to the correct size.

STEP 6

Snap the vinyl cover onto the retainer by inserting one side of the cover along the height of the retainer, and starting at one end, pressing the opposite side of the cover onto the retainer until it snaps into place (see **FIGURE 1**). Note: For flush mount corner guards that are floor to ceiling in height, the aluminum retainer and vinyl cover length is designed to go 1" above the finish ceiling.

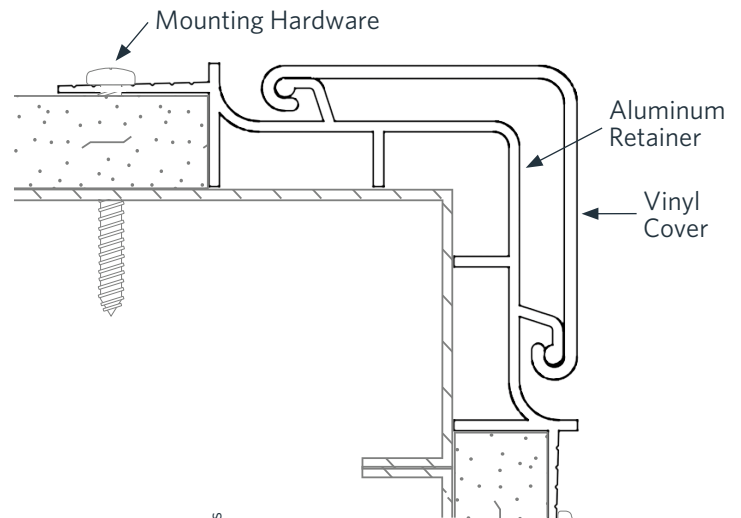

FIGURE 1

Drywall Setback Conditions

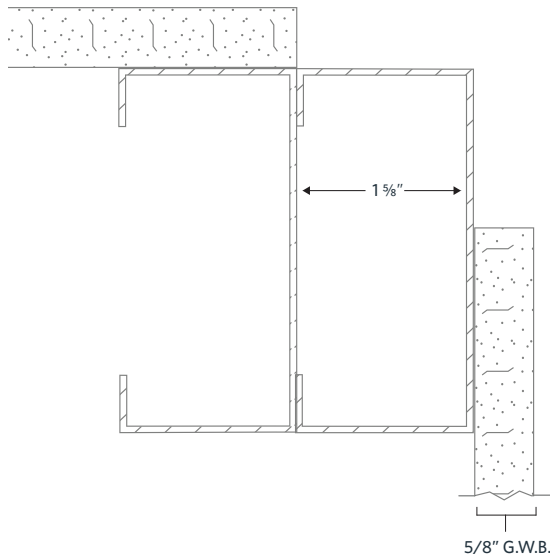

FIGURE 2
2", 90° Corner Guard

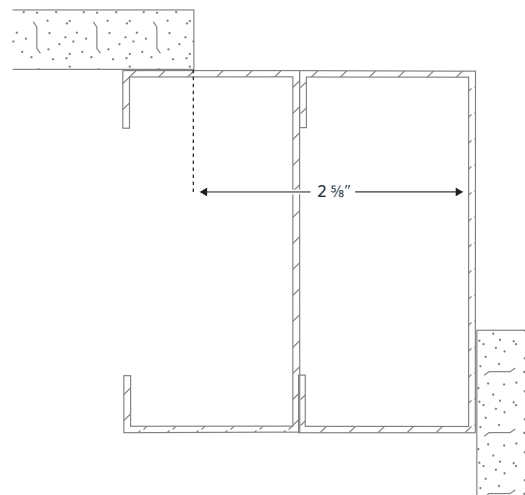

FIGURE 3
3", 90° Corner Guard



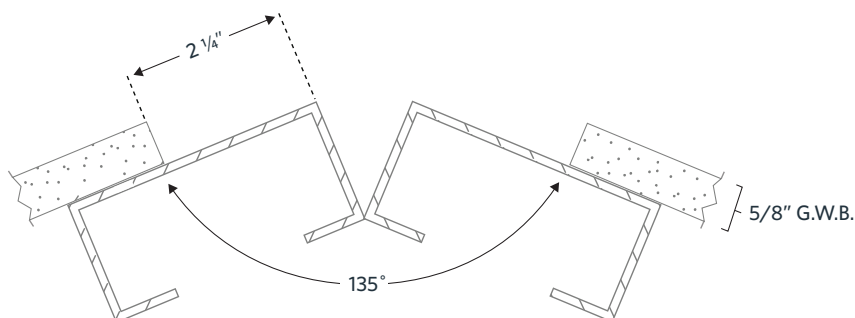

FIGURE 4
3", 135° Corner Guard



Cutting Flush Mount Corner Guards

Stock length material does not always have squared ends and may require squaring in the field. If space is available use a minimum 12' long cutting bench to allow the installer to cut the material without having to turn it around.



Storage & Handling

The corner guards are shipped unassembled. Upon receipt, the vinyl covers should be stored in the horizontal position at room temperature (70 ° F minimum). This is a finished product; store in a protected, clean and dry area away from direct sunlight.



Cleaning Instructions

STEP 1

For best results, the use of liquid cleaners such as "409," "Fantastic," and "Mr. Clean," etc. are recommended. The use of powder cleansers is not recommended. Use of such cleansers can leave residue which is difficult to remove.

STEP 2

Do not use chlorinated or aromatic hydrocarbons, esters, or ketones to clean Wallprotex vinyl products. Avoid the use of heavy degreasers, compounds containing surfactants, and abrasive compounds or cleaning devices.



Caution

DO NOT walk on the corner guards.
DO NOT store anything on top of the corner guards.

