

CTSO - POLYMER CONCRETE VAULT: 24x36

POLYMER CONCRETE VAULTS

Connect offers polymer concrete vaults from the Synertech line of Old Castle Moulded Products company. Vaults are also known as underground enclosures; hand wells, junction boxes or flush to grades. Applications could include pull box, fibre splicing, or cable storage. These units are a cost effective, easy to install alternative to precast concrete boxes.

The 24 x 36 vaults are available in the following depths: 18", 24", 36", 42", 48", 60" and 72". Our standard sizes are outlined in the Weights section. Standard vaults are open bottom, but closed bottom units are also available in the same depths.

The Polymer Concrete Lid provides a high vertical load rating for the best protection of both the vault and equipment in it. The Tier 20 Load Rating is suitable for driveway, parking lot, railroad right of way and off roadway applications subject to occasional non-deliberate heavy vehicular traffic.. A Split lid design makes it easy for a single technician access the vault. Other cover options are:

- Solid Polymer Concrete Cover
- Polymer Concrete Cover with Cut-Out for standard Cabinet/Pedestal mounting
- Solid Aluminum Cover (Split)
- Aluminum Cover with Cut-Out for Cabinet/Pedestal mounting

CONSTRUCTION DETAILS

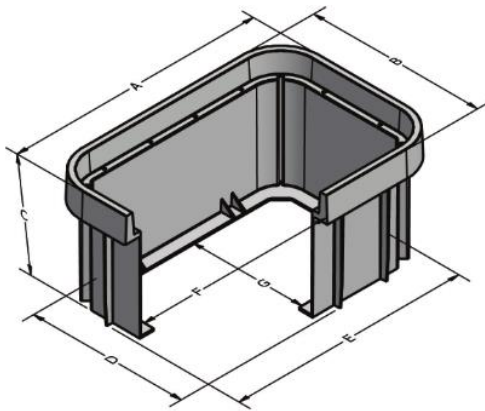

SYNERTECH

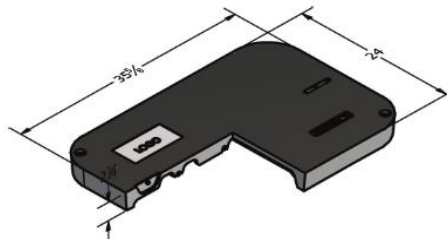

	A	B	C	D	E	F	G
2436-18	38-1/8	26-1/2	18	23-1/2	35-1/4	29-1/8	17-1/2
2436-24	38-1/8	26-1/2	24	23-1/2	35-1/4	29-1/8	17-1/2
2436-36	38-1/8	26-1/2	36	23-1/2	35-1/4	29-1/8	17-1/2



Heavy Duty: Incidental, Non-deliberate Traffic

For use in non-vehicular traffic situations only.

ADVANTAGES

- ✓ Manufactured in Canada
- ✓ Straight Wall Design with Monolithic construction
- ✓ High Density Polymer Concrete (HDPC) Ring and Lid
- ✓ Sheet Moulding Compound: Tough & Reduced Weight vs competition
- ✓ Unaffected by freeze or thaw
- ✓ Bodies are stackable to depths of: 36", 42", 48", 60", 72"

OPTIONAL ACCESSORIES

- Penta bolts (Hex is Standard)
- Grounding Options: Ground Plates, Ground Blocks & Jumpers
- Tracer Termination, Marker Discs & Marker Posts
- Fibre management Hooks

WEIGHTS & PERFORMANCE

- 24x36x18 Vault 82lbs
- 24x36x24 Vault 92lbs
- 24x36x36 Vault 110lbs
- PC Cover 130lbs (Solid Cover)
- ANSI/SCTE-77 Tier 22, WUC 3.6, ASTM C857 A-16

CONNECT

telecommunications solutions inc.

650 Rupert Street | Unit #6 | Waterloo ON | N2V 2R8
Phone: 519.748.4411 | 1-877-900-7996 | fax: 519.748.0466
customerservice@connect-telcom.com

www.connect-telcom.com