

# ALPA XO EXOSKELETON – QUICK REFERENCE GUIDE FOR FUJIFILM GFX 100

## INSTALLATION XO & GFX 100 WITH AND WITHOUT PL MOUNT

The ALPA XO exoskeleton is characterized by a high degree of functionality, versatility, and quality of craft. The design allows the camera and XO Exoskeleton to be wedded with ease in a few simple steps.

18 Feb 2020  
Release 1.0

XO

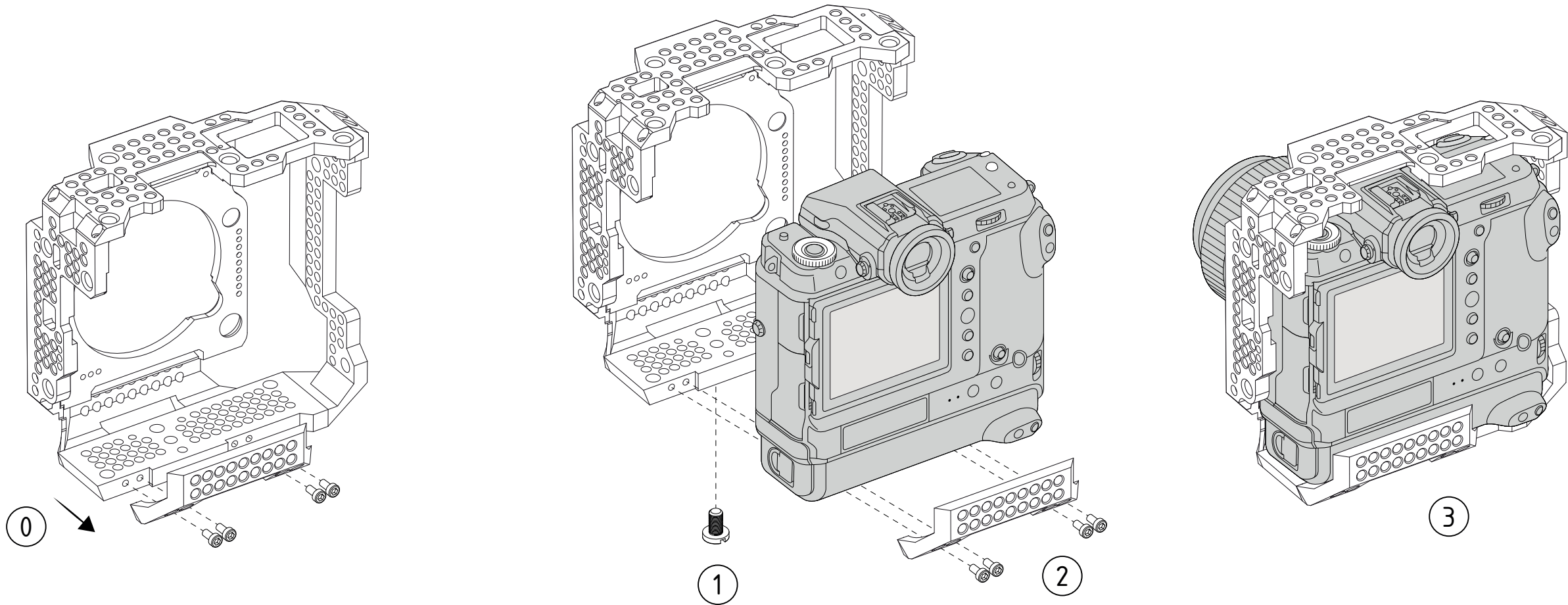

INSTALLATION WITH PL MOUNT: Follow step 0 - 7  
INSTALLATION WITHOUT PL MOUNT: Follow step 0 - 3 and 7

STEP	ACTION	TOOL ALPA
0	Remove rear bracket.	Swiss Tool
1	Remove main base plate screw	Stubby Tool
2	Insert GFX 100 body: The camera can be easily inserted into the assembled XO without disassembling the Exoskeleton. Insert screws 0 and 1 provisionally, without tightening them ultimately.	Swiss Tool Stubby Tool
3	Align the GFX 100 within the XO Exoskeleton for an optimal, tension-free position.	-
4	Attach the PL mount to the bayonet of the GFX.	-
5	Gently tighten the screws of the PL mount and base plate.	Swiss Tool
6	Carefully connect the PL mount and base plate to the Exoskeleton. Avoid mechanical stress in the assembly and reposition the camera body within the Exoskeleton slightly if necessary.	Swiss Tool
7	Now fasten the screw pair 2, 5, and 6. The screws should be easy to be tightened. Only finally complete the tightening of the central screw of the base plate.	Stubby Tool

