

Awning Hybrid

Global Windows and Doors manufactured products are structurally tested in accordance with AAMA/WDMA/CSA 101/I.S.2/A440-08 and -11 'NAFS' with the A440S1-09 Canadian Supplement. And energy performance tested in accordance with ANSI/NFRC 100, NFRC 200 and NFRC 500 as determined by the NFRC Standards accreditation agency.

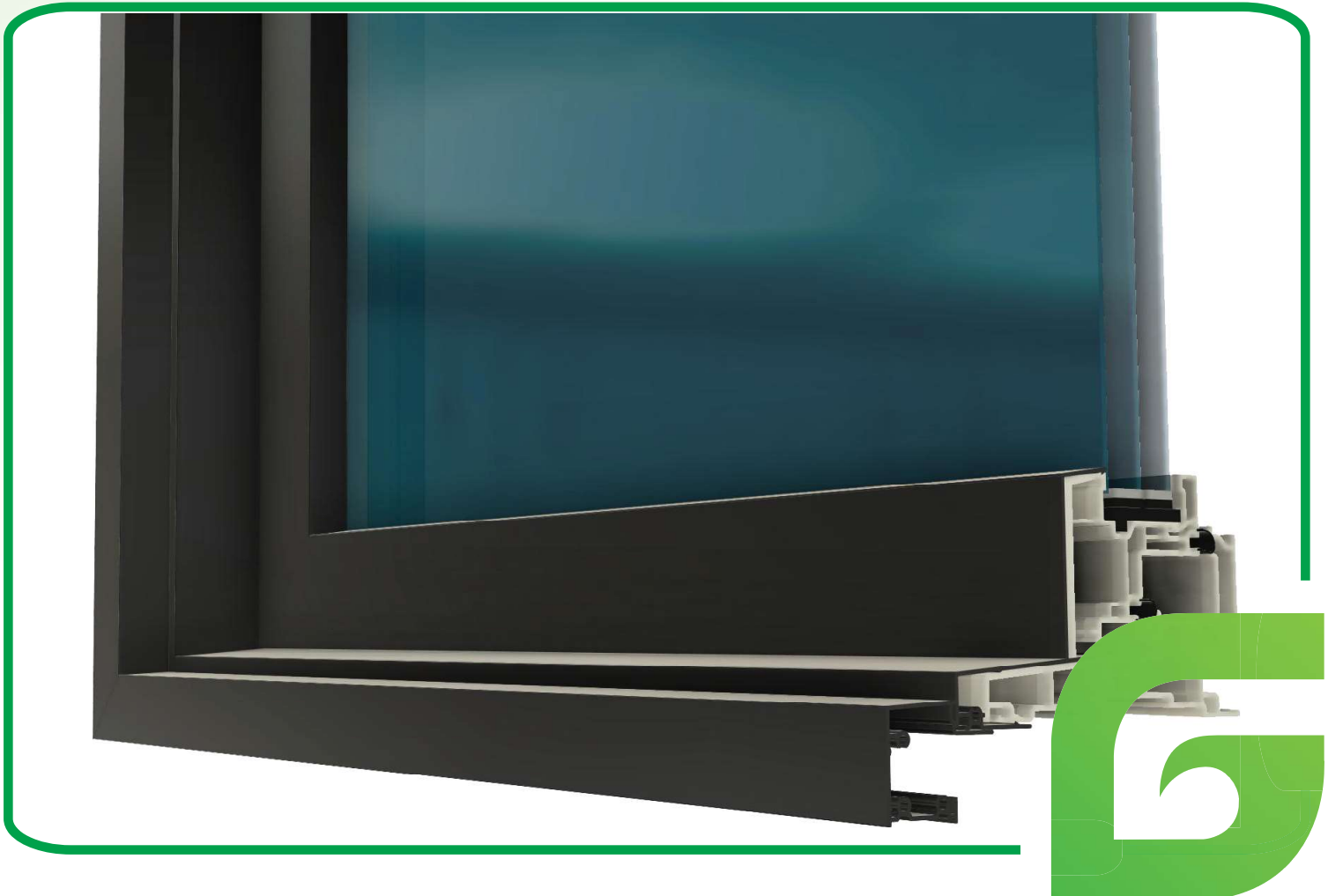

This energy efficient side hinged, outward projecting to a full 90 degree Aluminum Clad Hybrid Awning style window, complete with a finished geared ratio folding crank for ease of operation was conceptualized at Global Windows and Doors with durability and performance as our primary engineering design criteria. Incorporating durability and performance while exceeding Building Code of Canada and regional building code standards.



Awning Hybrid

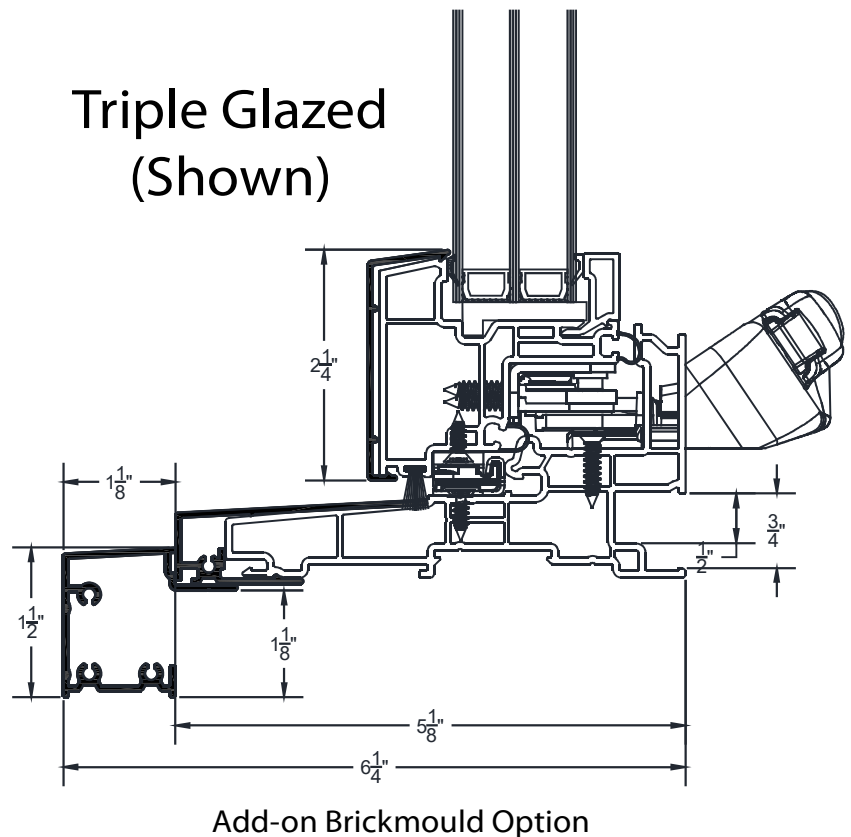
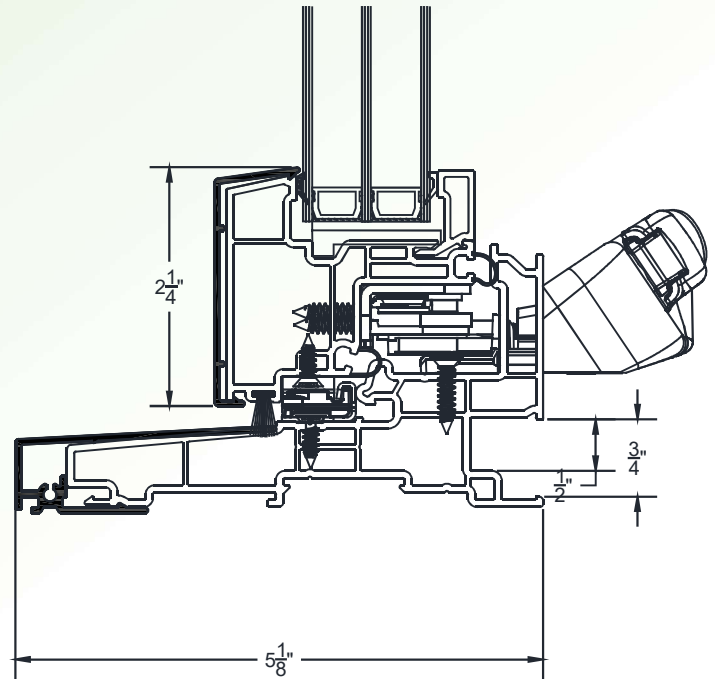
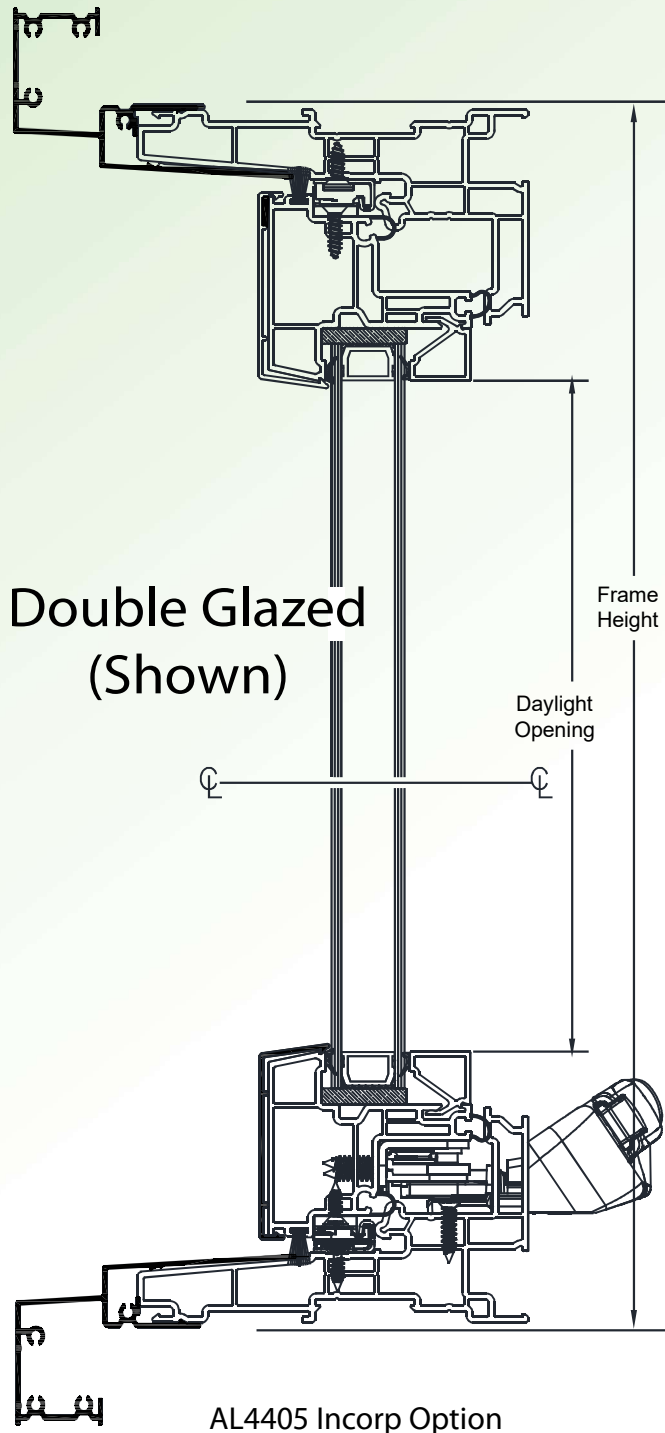

Awning Hybrid

Structural Mullion T-Post (Composite)

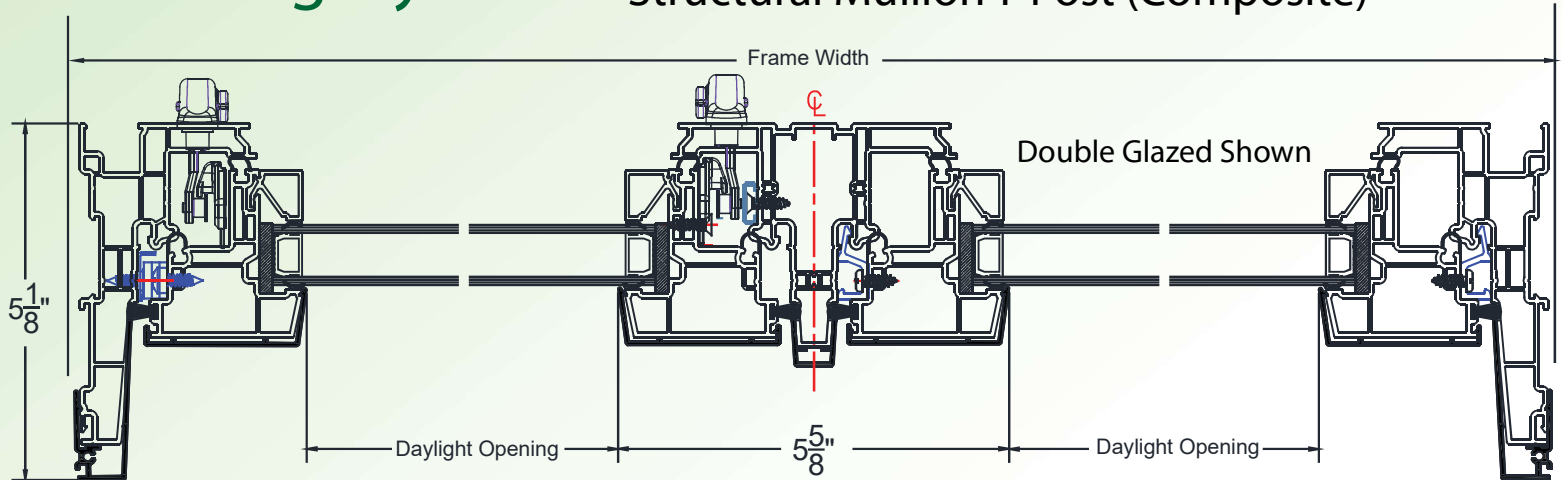

Reinforcement Option

T-Post
Reinforcement Option

2 x 1/2"

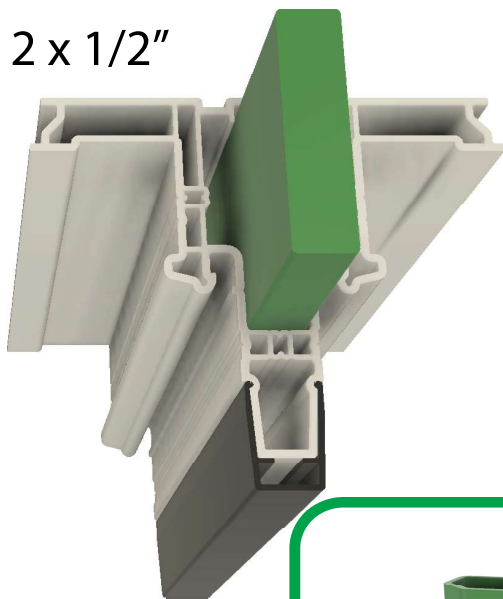

Sash
Reinforcement Option

14 Gauge Steel

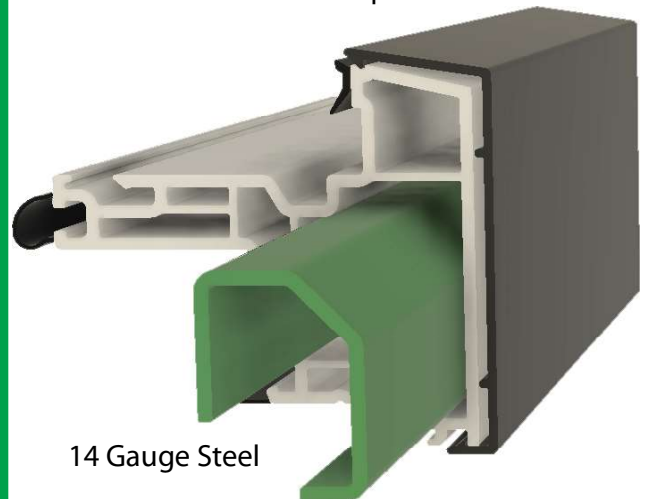

Nominal 0.050"
6063 Grade Aluminum
Cladding



Awning Hybrid

Mulled Combination

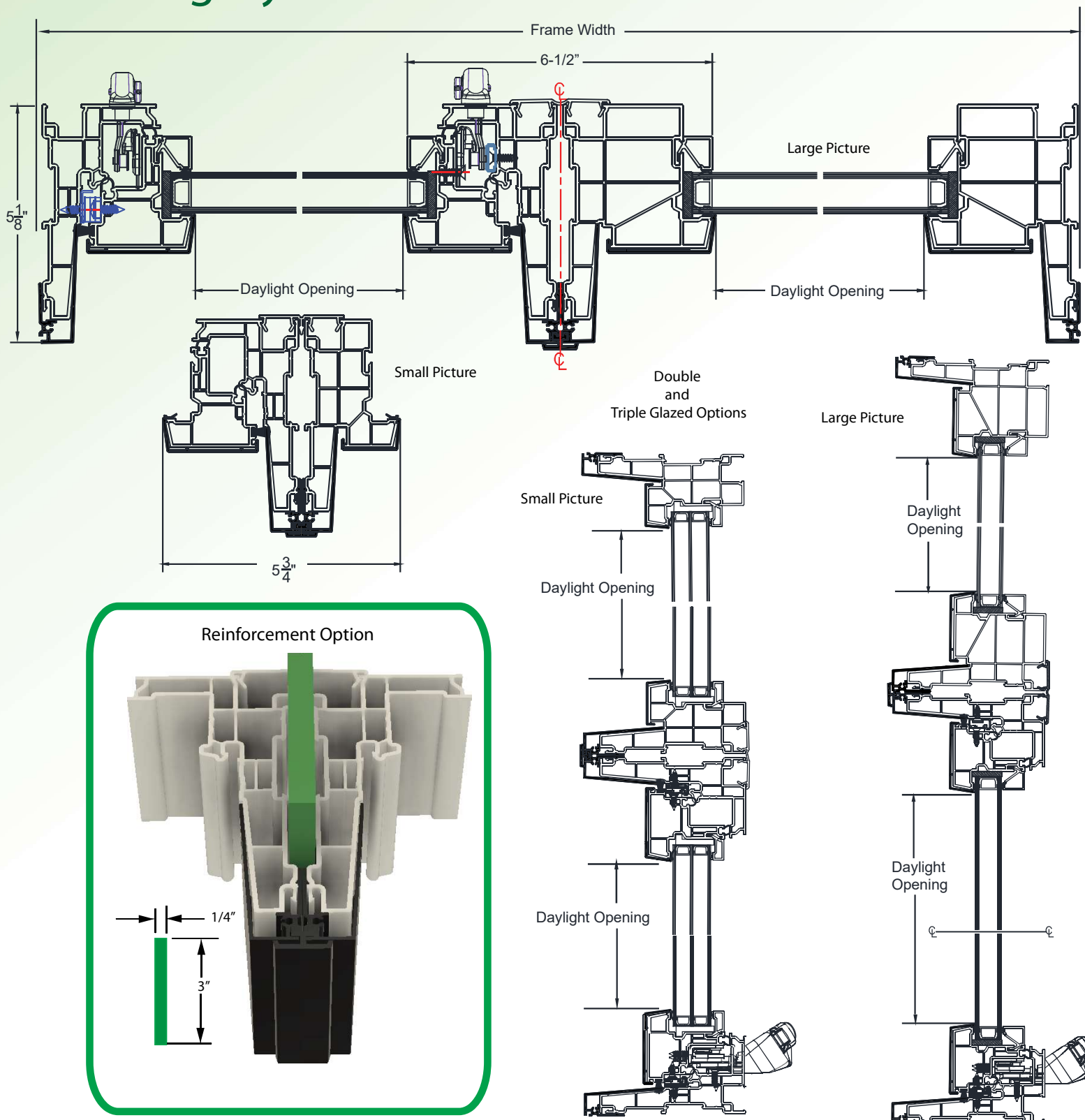

Awning Hybrid

NAFS

Based on the results of the testing summarized in Table 1, Global Windows and Doors, "3500 Series Aluminum Clad Awning" Window Unit, Exova Specimen No.: 13-06-M0432-2 met the following requirements as outlined in the NAFS - AAMA/WDMA/CSA 101/I.S.2/A440-08 and -11 "NAFS" with the Canadian Supplement A440S1-09 Window Standard:

Sizes Tested

SERIE #	REPORT #	DESCRIPTIONS	REINF.		DIM	CSA		NAFS
			Y	N		AIR	WATER	CLASS
3000 (3¼")								
3000	AI-04878-B1	Fixed window (architectural)		X	78 x 72	FIXED	720 Pa	CW-PG60-FW
3000 (4⅝")								
3000	13-06-M0432-2	Awning window		X	48 X 32	A3	730 Pa	LC-PG70-AP
3000	AI-04196-F2	Awning window		X	60 x 24	A3	730 Pa	R-CP45-AP

Reference: Test Report 13-06-M0432-2
Primary product designator:
Optional Secondary designator:

(Non-reinforced)

Class LC-PG70-C size tested 1,200 x 802 mm (48 x 32")
Positive Design Pressure (DP) = 3,360 Pa (70.0 Psf)
Negative Design Pressure (DP) = -3,360 Pa (-70.0 Psf)
Water Penetration Resistance = 730Pa (15.0 Psf)
Air Leakage Resistance = A3 Level Canadian

Reference: Test Report AI-04196-F2
Primary product designator:
Optional Secondary designator:

(Non-reinforced)

Class R-PG45-AP size tested 1525 x 610 mm (60 x 24")
Positive Design Pressure (DP) = 2,160 Pa (45.0 Psf)
Negative Design Pressure (DP) = -2,160 Pa (-45.0 Psf)
Water Penetration Resistance = 730Pa (15.0 Psf)
Air Leakage Resistance = A3 Level Canadian

Fixed (Sash) Casement

Reference: Test Report AI-04878-B1
Primary product designator:
Optional Secondary designator:

(Non-Reinforced)

Class CW-PG60-FW size tested 1,981 x 1,828 mm (78 x 72")
Positive Design Pressure (DP) = 2,880 Pa (60.15 Psf)
Negative Design Pressure (DP) = -2,880 Pa (-60.15 Psf)
Water Penetration Resistance = 720 Pa (15.0 Psf)
Air Leakage Resistance = FIXED

Awning Hybrid

NFRC SIMULATION IN ACCORDANCE WITH
ANSI/NFRC 100, ANSI/NFRC 200 AND NFRC 500

Our IG's are Hermetically sealed, using Guardian Float Clear and ClimaGuard 80/71, 70/36 and IS 20 LowE insulating glass with minimum 90% plus Argon and/or Krypton gas fill. Combined with a primary seal made of pressure sensitive acrylic adhesive Super Spacer® Premium warm edge high performance silicone with integrally incorporated desiccant. Our perimeter Secondary seal is made of Butyl Hotmelt all tested and IGMAC Certified (cert. No. 021141G) in accordance with CAN/CGSB 12.8 Standard.

Ar = Argon _{39.95} Kr = Krypton _{84.80}

Glazing Options

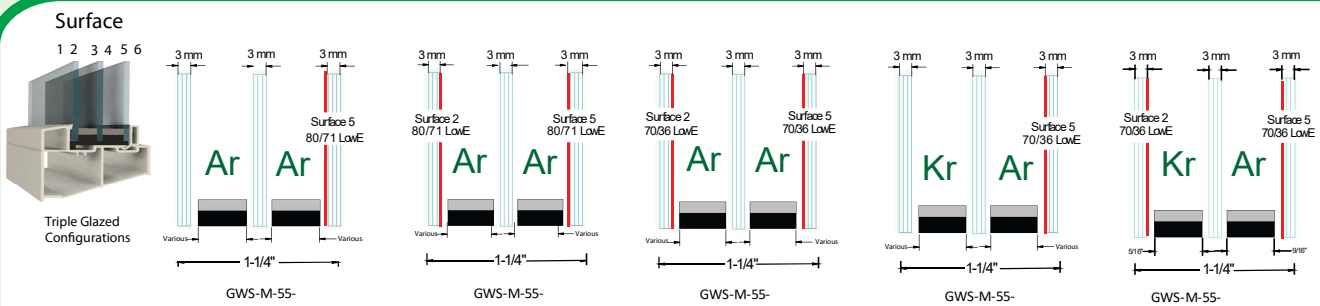

NRCan Searchable Product List	Option Name	Insulating Glass Unit		Overall Product					
		Glazing Layers	Grid	U Factor		SHGC	VT	CR	Energy Rating
				W/m2-K	Btu/hr-ft2-F				
GWS-M-54-	SP_3mm_8070#2-Arg90-ClrGuard-Arg90-8070#5	3	N	1.08	0.19	0.38	0.48		37
GWS-M-54-	SP_3mm_8070#2-Arg90-ClrGuard-Arg90-8070#5_Georgian8x18_Cover	3	G	1.1	0.19	0.35	0.43		35
GWS-M-54-	SP_3mm_7036#2-Arg90-ClrGuard-Arg90-7036#5	3	N	1.02	0.18	0.22	0.36		29
GWS-M-54-	SP_3mm_7036#2-Arg90-ClrGuard-Arg90-7036#5_Georgian8x18_Cover	3	G	1.04	0.18	0.20	0.32		28
				NRCan Most Efficient					
				Meets NRCan Certification					

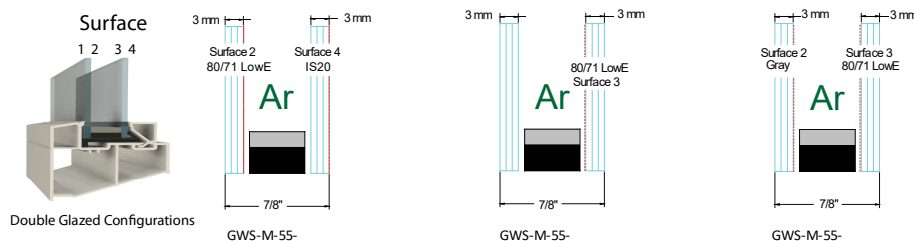

ENERGY STAR® Certified in Canada
Certifié ENERGY STAR au Canada



Canada
energystar.gc.ca

NRCan Searchable Product List	Option Name	Insulating Glass Unit		Overall Product					
		Glazing Layers	Grid	U Factor		SHGC	VT	CR	Energy Rating
				W/m2-K	Btu/hr-ft2-F				
GWS-M-54-	SP_3mm_ClrGuard-Arg90-8070#3	2	N	1.58	0.28	0.46	0.53		32
GWS-M-54-	SP_3mm_ClrGuard-Arg90-8070#3_Georgian8x18_Cover	2	G	1.58	0.28	0.42	0.48		30
GWS-M-54-	SP_3mm_ClrGuard-Arg90-8070#3_Rectangular	2	G	1.58	0.28	0.42	0.48		30

Awning Hybrid

Primary Seal

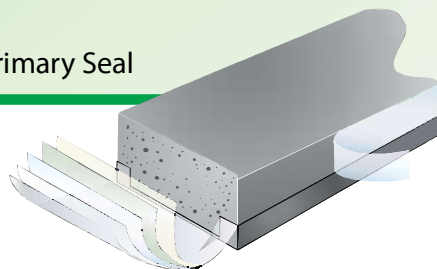

Quanex Super Spacer

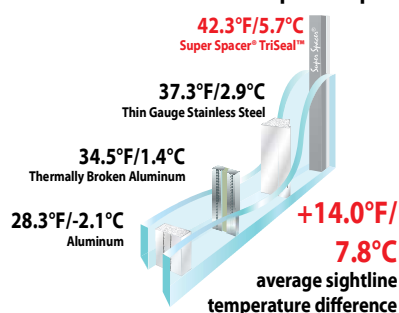

Secondary Seal

H.B. Fuller HL5130-149 Hotmelt butyl provides excellent adhesion to glass and resistance to moisture vapor for long term IG performance.

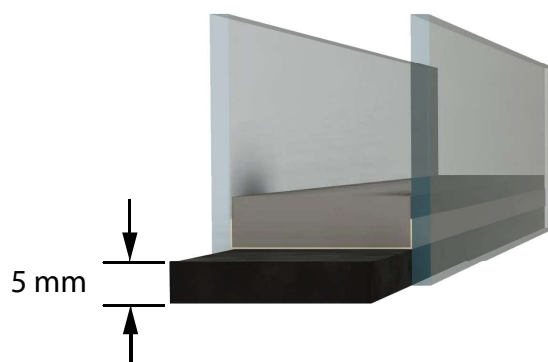

Code Compliant Child Safety Window Restrictor



Maximum
Opening

4" (101.6 mm)



Screens:

Rigid aluminum overlap bar frame assembled with PVC corners. Screen removable from interior. 16 x 18 Mesh Fibreglass screen cloth.

Paint:

This High Performance Paint system is designed for rigid uPVC and Aluminum and is offered in a wide variety of colors that can be formulated to meet customers specifications. This paint features superior abrasion and chalking resistance as well as excellent protection from salt exposure, industrial pollutants and acts as an efficient heat barrier that prevents substrates from warping.

Awning Hybrid

NOVA® Awning Family

INTERLOCK
ASSA ABLOY

NOVA® Awning Operator

- All NOVA® operators pass cycle testing for **Architectural Grade 40** with a minimum factor of safety of 2 (16K+ cycles)
 - highest industry rating
- All powder coated parts are pretreated with zinc chromate and UV resistant powder coating surpassing 750 hours Neutral Salt Spray resistance
- External connecting points are 304 stainless steel for maximum Neutral Salt Spray resistance
- Ability to achieve 5 lbs operational force on sash weights of up to 125 lbs



NOVA® Awning Hinge

- 18" NOVA® Awning Hinges for Awnings above 24". 10" Hinges for Awnings between 12 and 24"
- Awning hinge features friction adjustment to eliminate sash chatter
- Unique slide shoe positioning detent allows for faster sash to frame assembly time reducing manufacturing costs
- Simple snap-on spring clip design for quick and easy window assembly
- All pivot points use a non-corrosive material for superior corrosion resistance
- Arm assemblies are available in a 304 stainless steel option

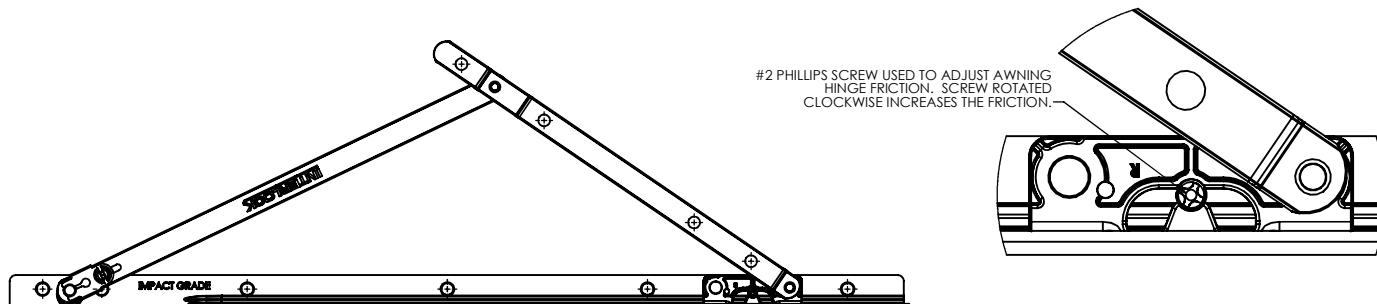

Awning Hybrid

NOVA® LOCKING Handle

- Super low profile with only 8 mm projection
- Handle retainer features brush gasket to provide insect barrier
- Available in powder coat and architectural finishes

NOVA® Awning Locking Handles

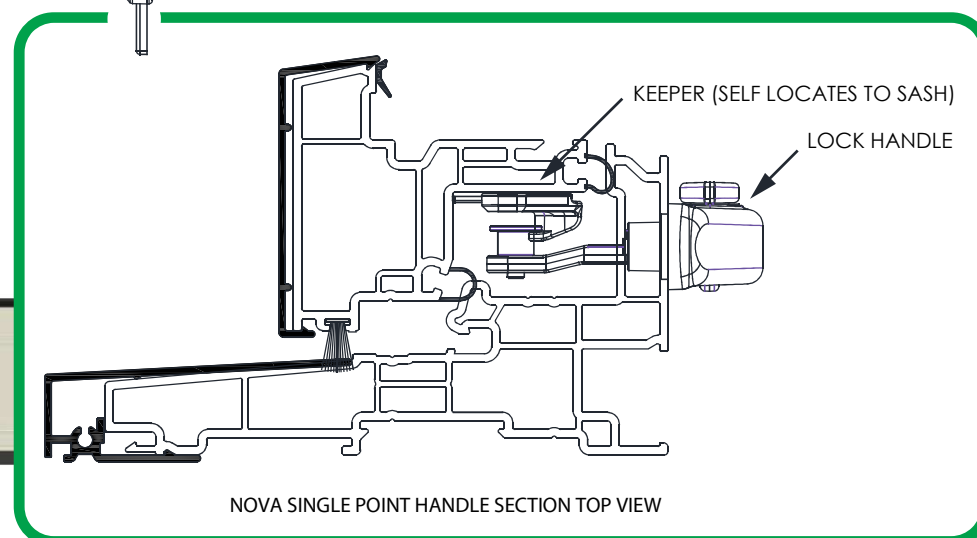
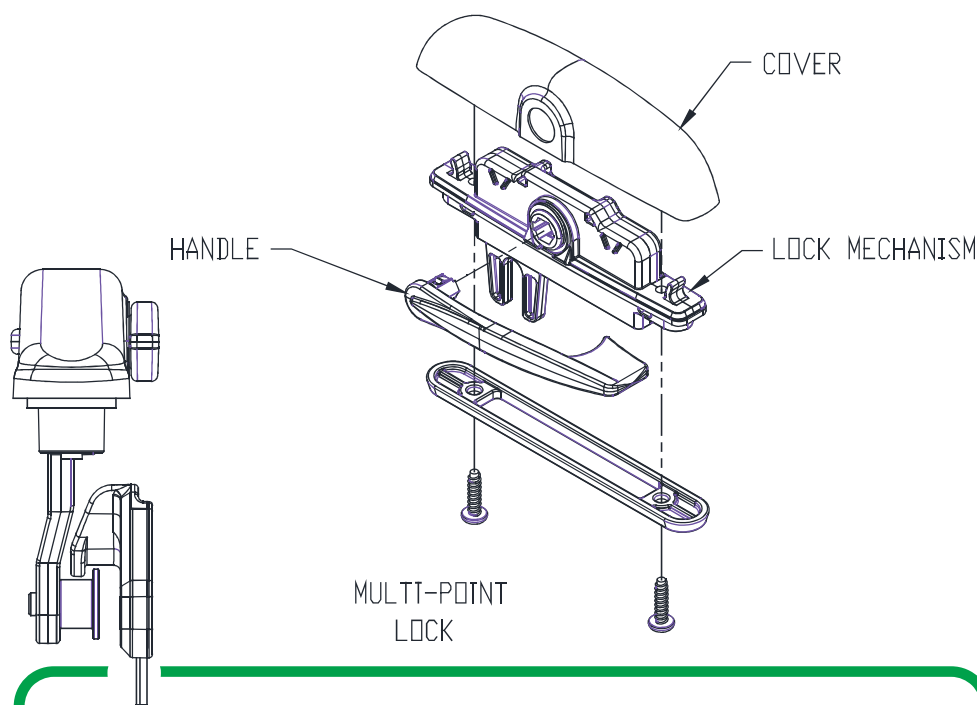

Awning Hybrid

Weatherstrip - Sealing

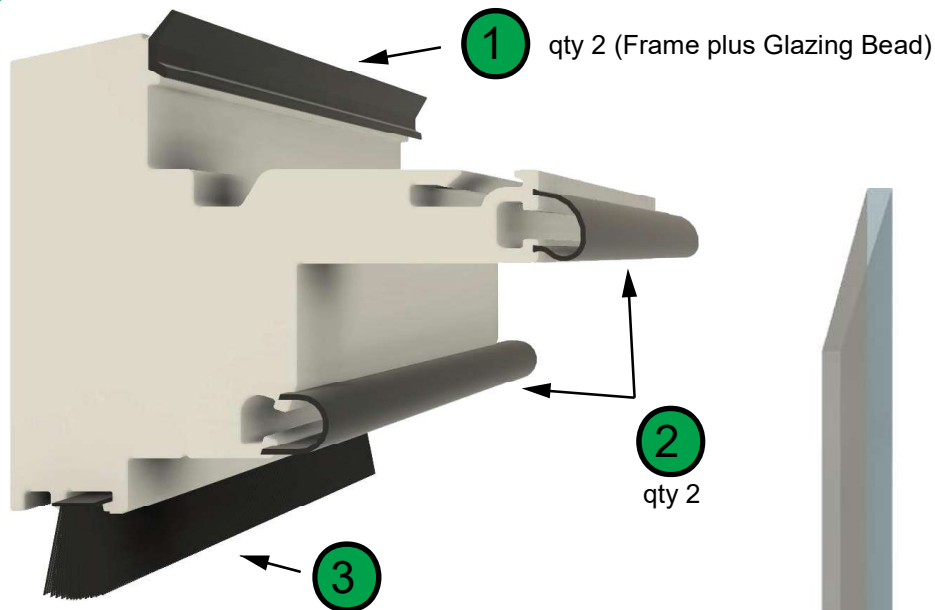

- 1 Primary non-apparent coextruded tension linear seal on both sides of glazing.

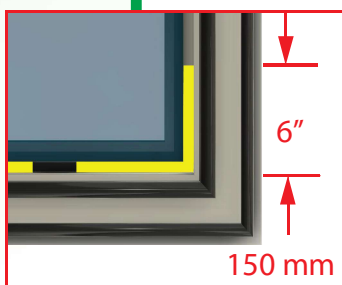

Tertiary high quality
ASTM C 1184 compliant
Structural Silicone Sealant
Back-bead across the bottom
and at least 150 mm up each
side.

- 2 Double Interior coextruded compression bulb seals.

- 3 T-Slot mount extruded continuous at corners fibre pile.



Awning Hybrid

SDL Options

Grill Options

Interior

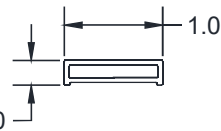
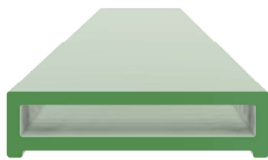

Exterior

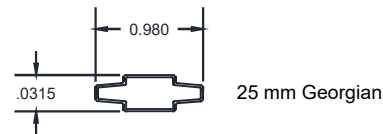
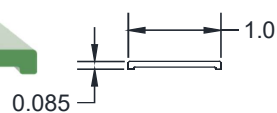
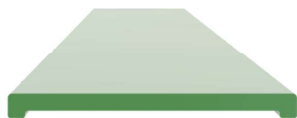

25 mm Georgian

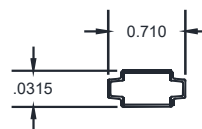

18 mm Georgian

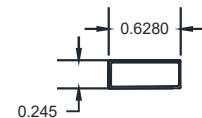
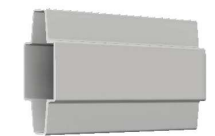

16 mm Colonial

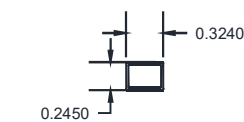

6 mm Colonial



6 mm Pencil



Heritage
(internal)

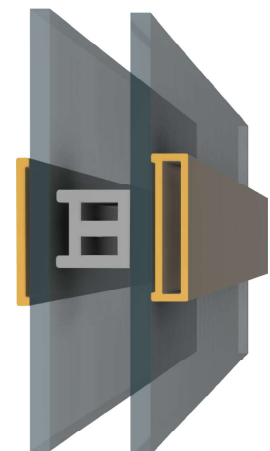
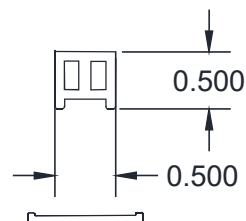

Awning Hybrid

NBCC 9.9 Compliant Specification/Standards - built in accordance with:

Canadian General Standards Board (CGSB)

- .1 CAN/CGSB-12.1-M90 - Tempered or Laminated Safety Glass.
- .2 CAN/CGSB-12.2-M91 - Flat, Clear Sheet Glass.
- .3 CAN/CGSB-12.3-M91 - Flat, Clear Float Glass.
- .4 CAN/CGSB-12.8-M90 - Insulating Glass Units.

Canadian Standards Association (CSA)

- .1 AAMA/WDMA/CSA 101/I.S.2/A440-[08][11] - NAFS - North American Fenestration Standard / Specification for Windows, Doors, and Skylights; including A440S1-09 - Canadian Supplement.
- .2 AAMA/NWDA 101/I.S. 2-97, Specifications for Aluminum, Vinyl (PVC) and Wood Windows and Glass Doors.

Insulating Glass Manufacturers Alliance (IGMA)

- .1 IGMAC Certification Program for manufacturers of insulating glass units.

National Fenestration Rating Council (NFRC)

- .1 ANSI/NFRC 100 – Procedure for Determining Fenestration Product U-Factors.
- .2 ANSI/NFRC 200 – Procedure for Determining Fenestration Product Solar Heat Gain Coefficient and Visible Transmission at Normal Incidence.
- .3 NFRC 500 – Procedure for Determining Fenestration Product Condensation Resistance Values.

Contact Details



128 Industrial Park St.
Richibucto, NB, E4W 4A4
Tel 506 523 4900
Fax 506 523 7003
Toll Free 1 877 675 5500

WWW.GLOBALWINDOWS.CA