

## Application info pack 2023

Applications open 1 June – 31 July 2022.

Goolugatup Heathcote Gallery is now seeking applications for its 2023 exhibitions program. Applications are open to solo artists, artist groups, curators, touring shows and institutions. We present both emerging and established artists. Artist fees are awarded to exhibitors.

### About the Gallery

The Gallery is located at Goolugatup Heathcote, 58 Duncraig Rd, Applecross. It sits above the shores of the Derbal Yerrigan, 10 minutes drive from the Perth CBD. Our exhibition program aims to show innovative, high-quality contemporary art. We usually present 14 exhibitions over a year.

Our space includes Main Gallery, Project Space, the Collections gallery showcasing the City of Melville's recent acquisitions, and a shop featuring locally-made products. Successful applicants will be invited to exhibit in either the Main Gallery or Project Space, depending on suitability and preference. Proposals to use non-standard gallery space are addressed on a case-by-case basis.

### How to Apply

Applications can be submitted by an online form. The form involves a project description and linking to CV and images. All applications are assessed by a selection panel against specified criteria. Spaces are limited, and selection is competitive.

Detailed information about exhibiting and applying is available below. If you have further questions, the Gallery Curator is able to discuss applications prior to submission – [heathcote@melville.wa.gov.au](mailto:heathcote@melville.wa.gov.au) or 9364 5666.

---

*Goolugatup Heathcote acknowledges the Bibbulmun people as the Traditional Owners of the land on which the City stands today and pays its respects to the Whadjuk people, and Elders both past and present.*

Goolugatup Heathcote nagolik Bibbulmen Nyungar ally-maga milgebar gardukung naga boordjar-il narnga allidja yugow yeye wer ali kaanya Whadjuk Nyungar wer netingar quadja wer burdik.

## Advice and Selection Criteria

We are excited by applications proposing new artworks that reflect current art and ideas, or that are sensitive to Goolugatup Heathcote's unique history and landscape.

### General advice for applicants

- Keep your writing clear and concise. Avoid waffle or jargon – simple is better.
- Use high-quality and relevant images. Include explanatory info in your captions if required.
- Tailor your proposal to our gallery, where relevant.
- Your CV should be up-to-date and specific to your arts career. If you are early-career, you may want to include a bio introducing yourself.

### Selection criteria

- Technical quality – is the artist's work well made for its purpose?
- Conceptual strength – does the project express a cohesive and coherent concept?
- Ingenuity – is it inventive, original, or avant-garde?
- Audience engagement – could it connect audiences to important or current ideas?
- Suitability – is it a good fit for the gallery, does it further our program, and is it achievable in scope?

People of culturally and linguistically diverse backgrounds and people of Aboriginal and Torres Strait Islander descent are encouraged to apply.

## Exhibiting at the Gallery

- Exhibitions run for approximately six weeks. This includes a three to four day installation and a one-day deinstall. The Gallery has multiple exhibition spaces and exhibitions run simultaneously. Exhibition duration may be open to negotiation by both parties.
- The Gallery is open Mon-Fri 10pm-4pm, Sat-Sun 12pm-4pm. We are closed public holidays. During opening hours we are attended by a staff member who can answer public enquiries and manage any art sales.
- The Gallery has AV equipment for exhibitors use, subject to availability. These include a dedicated darkened AV room with projector, audio, remote media player, and 16:9 projection screen. We also have 2x 4kTVs, Raspberry Pi 4, 3x headphones, and a compact short-throw projector. Discuss your requirements with the Curator, as we may be able to source other equipment.
- The Project Space includes two rooms – artists can use one of these rooms or both. The Main Gallery includes one large room, plus optionally three cells, and an AV room. See floor plan at end of document.
- The majority of gallery spaces have track lighting and jarrah floor boards. The building is heritage, so we are unable to make new fixings into floors, walls, or ceilings. We use a wire hanging system to hang work on D-rings. Very light-weight works can be fixed with specific adhesives with the permission the Gallery Curator. We have many plinths available for sculptural work.
  - Over the period 2021 – 2023 selected portions of the Gallery will be clad with false walls and ceiling suspension points. When complete, this will allow for fixing straight into walls and hanging from ceilings in those areas. Details of this project timeline can be discussed with the Curator.

## Artist Fees and Sales

- Artists are paid to exhibit at Goolugatup Heathcote. \$2,786 is awarded to each exhibition in Main Gallery, and \$2,193 to each in the Project Space. These fees are based on NAVA rates.
- Artists are able to offer exhibited artworks for sale. The Gallery administers these sales. We take a commission rate of 25% (plus GST) on art sales. This is a low rate in the sector, and it applies to works sold in preview, opening, and exhibition periods. Commercially represented artists need to discuss their arrangements with the curator before committing to exhibit.
- Goolugatup Heathcote covers artists under its public liability insurance. More information will be available in the Exhibition Agreement. Artworks can also be insured by exhibitors, if necessary.
- In the unlikely event an artist damages the gallery space a security bond of up to \$300 may be deducted from artist fees.

## Media and Promotion

- Main Gallery exhibitors receive a full colour catalogue in A3 French-fold format. Design, print, and distribution managed by the Gallery.
- All exhibitors are supported by Gallery social media promotion, e-news mailouts to our extensive subscriber lists, and targeted promotion to arts writers and platforms where appropriate.
- All exhibitors are provided a full roomsheet including works, maps, acknowledgments, and brief text (up to 700 words) if required.

## Installation

- A standard exhibition installation runs three to four days beginning from midday Monday. De-installation begins 4-5pm Sunday, and continues until midday Monday.
- Exhibitors can discuss delivery of artwork to the gallery in the week leading up to the install. Unfortunately, we are unable to pay transport costs. Works must be delivered during or immediately before installation, and removed immediately after de-installation.
- Artists install their own exhibitions, however Gallery staff will be available to assist and provide guidance. Other arrangements may be discussed with the Curator.
- The Gallery uses track lighting (LED wall washers and spot lights). These are set by Gallery staff during install in consultation with exhibitors.
- The gallery uses a wire hanging system on its masonry walls requiring works to be hung using D-rings. All artworks should be ready to hang prior to installation. Other arrangements need to be approved prior to installation.
- Goolugatup Heathcote is an important historical site, and no drilling into masonry walls or ceilings is permitted. Painting of walls can be discussed with Gallery Curator.
- Please supply your own tools and consumables. (The City of Melville will not accept responsibility for loss or damage to the Exhibitor's own equipment). The Gallery also has some equipment that our staff can use to assist in install.
- The Gallery Curator remains responsible for final presentation and the approval of material for exhibition.

## Accessibility

- The gallery is wheelchair accessible and ACROD parking is available nearby. Main entry is 1.4m wide, and accessible toilet doors are 0.9m wide. Toilets are unisex. If you require an AUSLAN interpreter please contact us.
- Load-in for exhibitions is easiest done via loading parking bays directly adjacent to the Gallery. If you require us to reserve bays with traffic cones, let us know. If you require assistance loading in or with heavy items, let us know.

## Openings and Engagement

- Openings run for two hours from 6.00pm. They are usually on a Friday.
- Openings for multiple exhibitions are usually held simultaneously. Most openings are paired with live music events – Goolugatup Sounds. Your exhibition sits within Goolugatup Heathcote's wider artistic program.
- The Gallery provides staff during the opening to welcome guests, take sales, and run a bar. The bar offers drinks free 6-7 and then paid. Alternative or additional arrangements are at the cost to the artist.
- Opening night speeches usually run from 6:45. These often include a very brief acknowledgement and speech from the curator, and a brief thank you from the exhibitor. Arrangements can be discussed with the Curator well ahead of the opening.
- Artist talks or other public programs can be arranged in discussion with the Curator. Artist talks are often held on the final weekend of the exhibition period. The Gallery can help facilitate these events.

For further information please contact Gallery Curator: (08) 9364 5666 or [heathcote@melville.wa.gov.au](mailto:heathcote@melville.wa.gov.au)

Gallery floorplan c2022

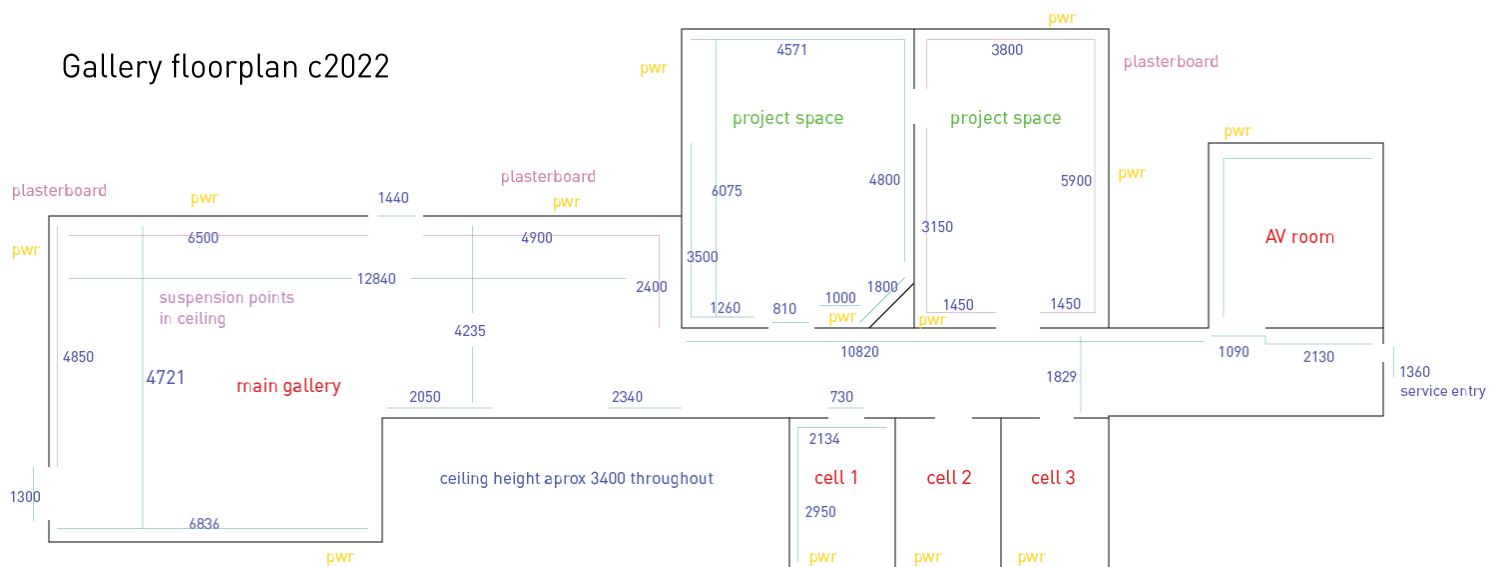

## **COVID-19 and your Exhibition**

- Please note your exhibition is subject to State and Local Government health regulations and may be modified/ cancelled at short notice and at any time.
- In the event of disruption we will work in good faith to present the exhibition in a modified and mutually acceptable format. If this is not possible and the exhibition must be cancelled, we will in good faith discuss the payment of any related development costs and artist fees.