

HEATHCOTE SELECT 2019

Sacha Barker, Samuel Bennett, Medeleine Beech, Natsumi de Dianous,
Stephen Peacock, Ómra Caoimhe, Chloe Henderson

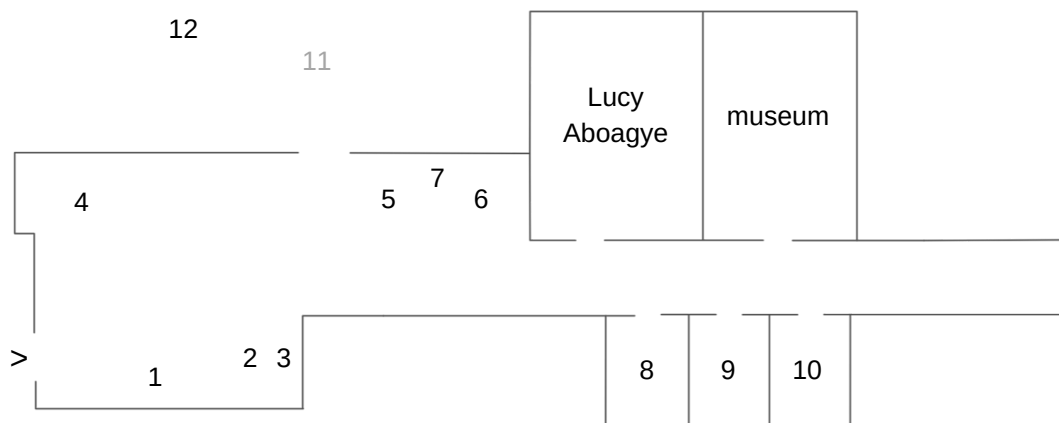

- 1 Madeleine Beech, *Broad Bean Findings (I-III)*, 2019, wood, broad beans, clay paint, MDF, 45 x45cm. \$300 each (central panels).

Madeleine Beech, *Broad Bean Findings (IV-V)*, 2019, wood, broad beans, clay paint, MDF, 45 x45cm. \$200 each (left and right).
- 2 Madeleine Beech, *Pillar Findings (I-VIII)*, 2019, wooden posts, beans, clay paint, variable dimensions. \$150sml/ 200lrg each.
- 3 Madeleine Beech, *Fishing Reel Findings*, fishing reels, wood, clay paint, variable dimensions, 2019. NFS.
- 4 Sacha Barker, *Heathcote: The Fear (SWS3)*, 2019, hand embroidered text, black thread on calico, pins, needles, upholstery thread, dimensions variable. NFS.
- 5 Natsumi de Dianous, *Springsky wavering (I)*, 2019, oil, acrylic, thread, D-ring, blutac on calico, pencil on paper, 105x74cm. \$350.
- 6 Natsumi de Dianous, *Springsky wavering (II)*, 2019, oil, acrylic, thread, D-ring, blutac on calico, pencil on paper, 105x74cm. \$350.
- 7 Natsumi de Dianous, *wavy earrings*, 2019, jewellery pieces, chain, lucky charms, dimensions variable. \$30 each.
- 8 Chloe Henderson, *Satellites (I-IV)*, 2018-2019, cardboard, MDF, metal, ceramics, acrylic paint, LED lights, magnifying lenses, found objects. \$700 for set (without tripods).
- 9 Samuel Bennett, *Doll Boy*, 2019, LED, pink acetate gel sheeting, oak wood carver chair. 290x140x90cm. \$700.
- 10 Ómra Caoimhe, *Splinter*, 2019, wardrobe pieces, un-carded fleece, hand-spun thread, oil, dimensions variable. \$400 (per wardrobe piece), \$650 (entire installation).
- 11 Stephen Peacock, *The Wander Box*, 2019, mixed media, performance, dimensions variable. NFS.
- 12 Sacha Barker, *Submission Box*, stainless steel, marine screws, hose clamp, wire rope, pencil, paper, 16x16x29cm. NFS.