

# SINUS CRESTAL APPROACH KIT

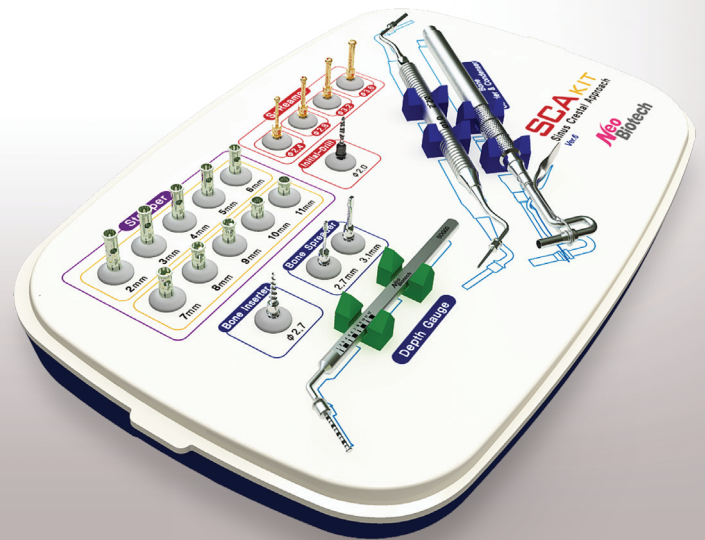

SCA kit is an effective tool for crestal sinus elevation by perforating inferior cortical wall and lifting sinus membrane without any rupture or membrane tearing.(1,200 RPM with irrigation)

## 1 SAFETY

- S-reamer's head with a special blade structure
- is designed to perforate the sinus inferior cortical bone without sinus membrane tearing and it makes thin bone disk between membrane and reamer. Since the reamer does not touch sinus membrane directly, so it is safer.

## 2 SPEEDY

- With 1,200 RPM high speed drilling with enough irrigation, it perforates sinus cortical wall safely and rapidly without any sinus membrane damage.

## 3 SIMPLE

- SCA kit is designed user-friendly to minimize the operators' experience gap and sinus lifting techniques, therefore all users can conduct sinus lift easily.

## Sinus Crestal Approach Kit Intended use

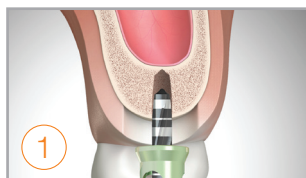

### 1st Drilling

- Make drills 1mm shorter than measured height of residual bone. Drill only 1mm more in each step by step using 1mm longer stopper before the final drilling.

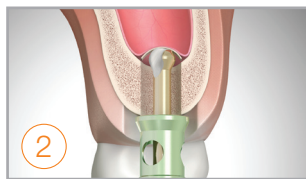

### Using S-reamer

- For safety, select a proper S-reamer in diameter and 1mm shorter than measured height of remained bone. And make drills.
- If the sinus inferior cortical wall doesn't perforate until the stopper reaches to the crestal bone, change 1mm longer size stopper and drilling continuously.
- You can feel perforating in inferior cortical wall.

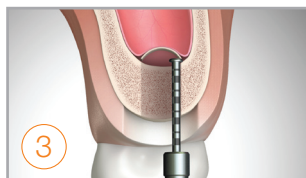

### Check perforation

- Using Depth Gauge, check whether being perforated. Then, hang on the end of depth gauge in sinus wall inside. And check whether the tip side of gauge is hung on the interior wall.

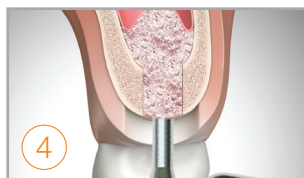

### Bone carrier

- Carry the bone grafting materials into osteotome site.
- One time insertion capacity 0.05cc.
- To make 1mm graft height, 0.1cc is needed.

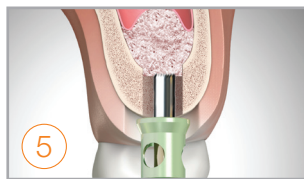

### Bone condenser

- Push and keep the graft materials in place on the floor of the sinus through the osteotome site.

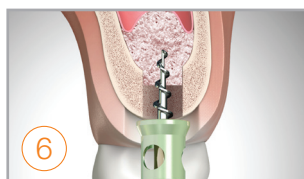

### Bone inserter

- Push the bone into sinus after inserting the bone into a hole with bone carrier.
- Can be safely used with 1mm long stopper. 80rpm speed.

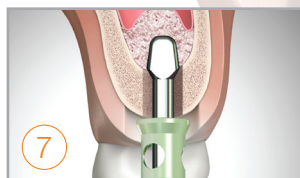

### Bone spreader

- Spreading the bone and reduce pressure in sinus area. 80rpm speed.
- Use bone spreader at least after inserting the bone more than 2 times.

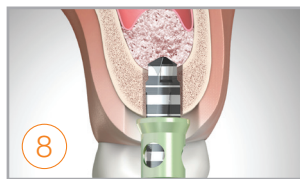

### Final Drilling & Implantation

- Do a Final Drilling
- Based on the density of Crestal cortical bone, the Countersink should be done (Except IT Type of Fixture). Generally, it should be done for D1-D2 bone. But, in case of below of D3 bone, it is Okay to skip according to the decision of dentist.
- After finishing a whole of drilling, do a implantation.

### CMI Fixation

CMI Fixation is a new implantation technique which is presented by Dr. Young Ku, Heo It is for effective initial fixation at mixed bone's each part such as hard-soft bone and an abbreviation for crest cortical, Middle cancellous and Inferior cortical Fixation, especially it is an important concept for effective fixation at Middle cancellous bone and inferior cortical bone.

**C** Fixation is method which removes enough Crest cortical bone and then makes a final implantation, the fixture can be fixed passively without over-compression.

**M** Fixation is method which is clean and best getting the best fixation from soft bone.

**I** Fixation is method of gaining strong fixation inner sinus inferior cortical wall by making a small hole.

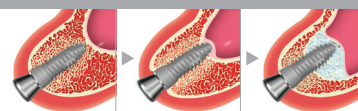

## Ordering information

Catalog Number	Description
SCAKIT	Sinus Crestal Approach Kit

### Neobiotech Co.,Ltd

104, 24 / 102, 103, 104-1, 104-2, 105, 106, 205, 212, 312, 509, 510, 511, 10F,  
36 Digital-ro 27-gil, Guro-gu, Seoul, Korea Tel 82-2-582-2885, Fax 82-2-582-2883  
www.neobiotech.com / Made in Korea

### Dongbang Acuprime

1 Forrest Units, Hennock Road East, Marsh Barton, Exeter EX2 8RU, UK  
Tel +44 1392-829500 Fax +44 1392-829232

**Neo  
Biotech**  
Satisfaction to Dentists