

## 75 Wynford Heights Crescent, North York M3C 3H9

TOTAL APPROX. FLOOR AREA 1,420+240 SQ.FT

Whilst every attempt has been made to ensure the accuracy of the floor plan contained here, measurements of doors, windows, rooms and any other items are approximate and no responsibility is taken for any error, omission, or misstatement. This plan is for illustrative purposes only and should be used as such by any prospective purchaser.

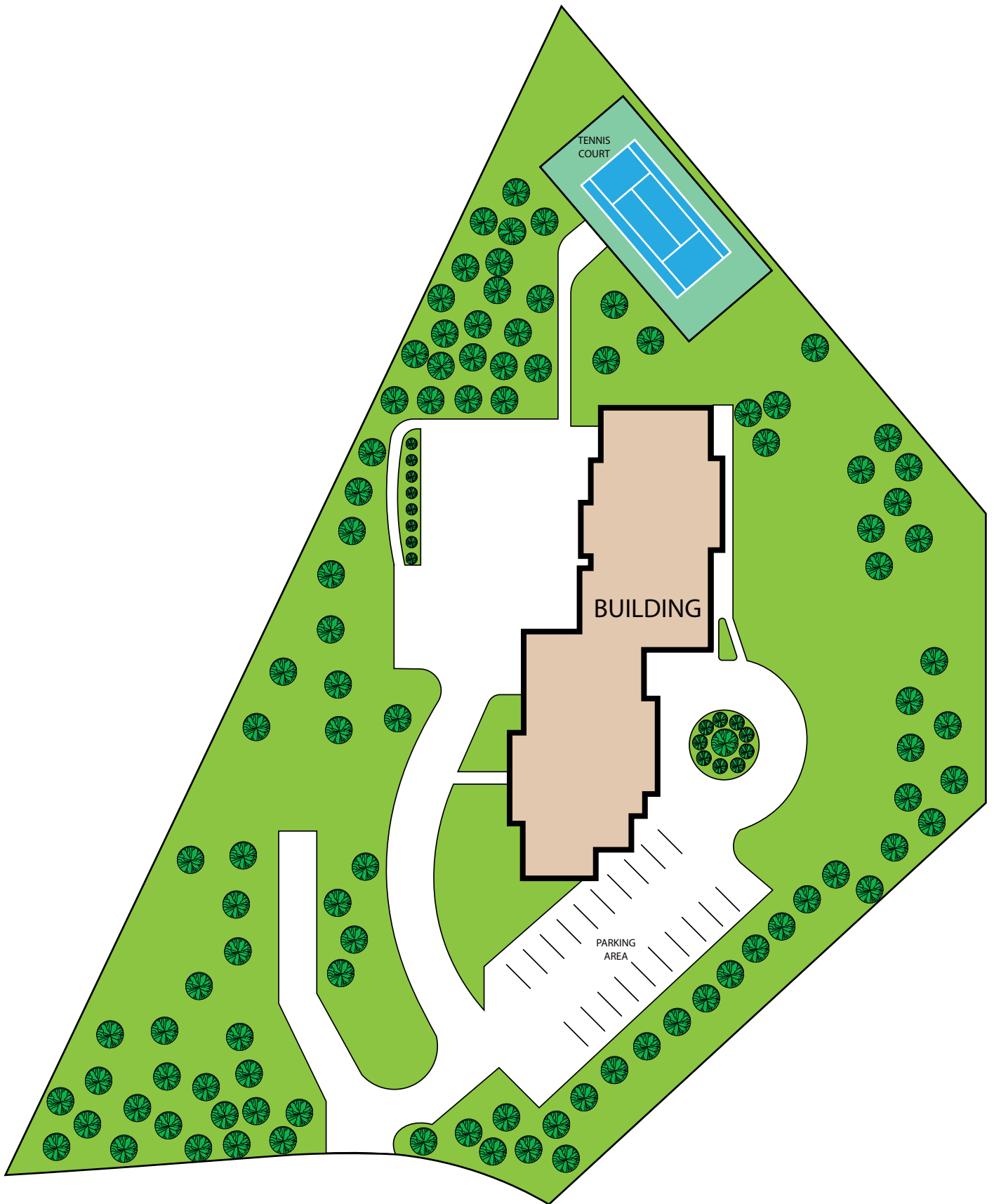

## 75 Wynford Heights Crescent, North York M3C 3H9

Whilst every attempt has been made to ensure the accuracy of the floor plan contained here, measurements of doors, windows, rooms and any other items are approximate and no responsibility is taken for any error, omission, or misstatement. This plan is for illustrative purposes only and should be used as such by any prospective purchaser.

Floor Plan		
Room Description	Metrics	Imperial
Primary Bedroom	4.8 x 3.6	16'0" x 11'10"
Ens	3.1x 1.8	10'4" x 6'2"
Living/Dining	5.4 x 5.7	18'0" x 18'10"
Kitchen	2.7 x 2.4	8'10" x 14'0"
Bedroom 2	2.9 x 5.1	9'8" x 17'0"
Bedroom 3	2.9 x 4.2	9'6" x 14'0"
Bath	1.5 x 1.9	5'0" x 6'5"